

# SOFT54

## Single Orifice Float Trap with SLR

### Description

The Forbes Marshall Single Orifice Float Trap with SLR, SOFT54, is a carbon steel single orifice float trap with stainless steel internals. It has integral manually adjustable needle valve, which is used as a steam lock release.

### Sizes and Pipe Connections

DN25 flanged to ANSI B 16.5 class 600

### Limiting Conditions

SOFT54 with built-in Steam Lock Release arrangement

Body design condition	Class 600
Max. operating temperature	425°C
Max. operating pressure	42 barg
Max. differential pressure	42 barg
Min Operating Temperature	0 °C
Cold Hydraulic test Pressure	63 bar g

### Operating Range

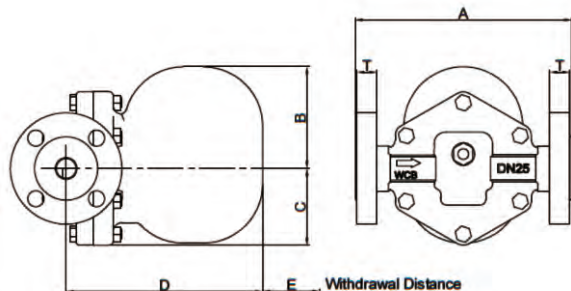
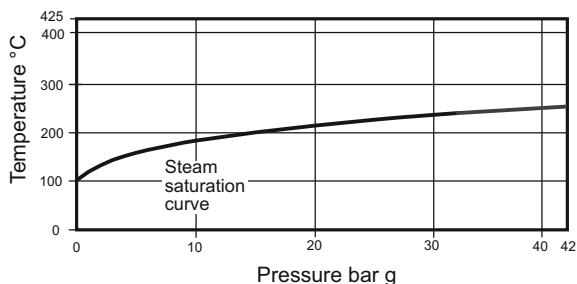

### Dimensions (approx.) in mm and kg

Size	A	B	C	D	E	T	Weight
DN25	240	119	88	225	160	24	30 kg

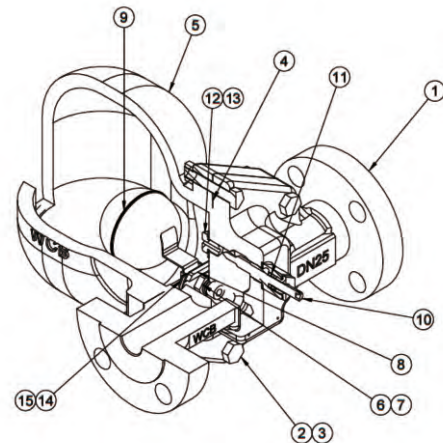

### Materials

No	Part	Material	Standard
1	Base	Cast Steel	ASTM A216 Gr. WCB
2	Bolts	Alloy steel	ASTM A 193 B7
3	Nuts	Alloy steel	ASTM A 194 2H
4	Cover Gasket	Reinforced exfoliated graphite	
5	Cover	Cast Steel	ASTM A216 Gr. WCB
6	Valve Seat	Stainless Steel	ASTM A743 Gr. CA40
7	Valve Seat Gasket	Stainless Steel Type 410	ASTM A240
8	Pivot Frame Assy. Set Screws	Stainless Steel Type 304	ASTM A240
9	Ball Float & Lever	Stainless Steel Type 304	ASTM A240
10	SLR Stem	Stainless Steel Type 316	ASTM A276
11	Gland Packing	Graphite	—
12	SLR Seat	Stainless Steel	ASTM 743 Type CA40
13	SLR Gasket	Stainless Steel Type 410	ASTM A240
14	Support Frame	Stainless Steel Type 304	ASTM A240
15	Pivot Frame	Stainless Steel Type 304	ASTM A240

## Capacity Chart

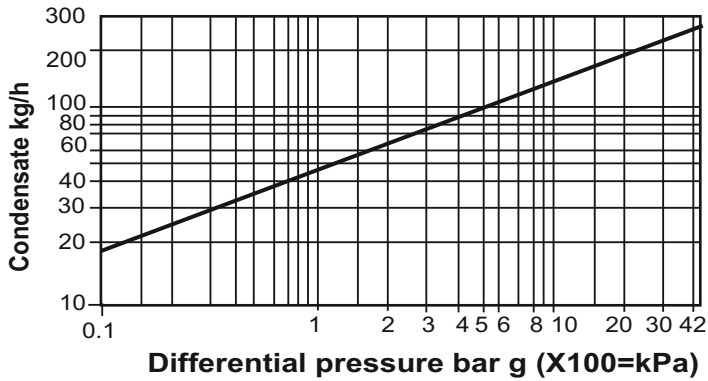

## How to Order

DN 25 Single Orifice Float Trap  
SOFT54 SLR, flanged ASA 600

## Installation

The trap must be fitted with the direction of flow as indicated on the base and with the float arm in the horizontal plane so that it rises and falls vertically.

## Maintenance

Before undertaking any maintenance on the trap it must be isolated from both supply line and return line and any pressure allowed to safely normalise to atmosphere. The trap should then be allowed to cool. With suitable isolation repairs can be carried out with the trap in the line. When re-assembling, make sure that all joint faces are clean and the dowel locates in the cover. Once completed, open isolation valves slowly and check for leaks.

## How to Fit Main Valve Assembly

Unscrew support frame, pivot frame and valve seat. Ensure seat / gasket faces are clean and dry. Fit the valve seat to the body (do not use gasket paste). Attach the support frame and pivot frame to body with assembly set screw but do not tighten. Fit the float arm to the pivot frame using the pin and by moving the complete assembly centre the valve head on to seat orifice. Tighten the assembly set screws.

## Spare Parts

Mention trap size while ordering spares.

## Available Spares

Main valve assembly with float	A
Set of gaskets (pack of 3)	C
Float assembly	B
Steam lock release assembly	D

## How to Order Spares

Always order spares using the description given in the column above, headed "Available Spares", and stating the size and type and differential pressure of the trap. For codes refer the user manual.

## Recommended Tightening Torques

Part	Torque (Nm)
Cover bolts	25-35
Valve seat	45-55
SLR body	60-70
SLR seat	45-55

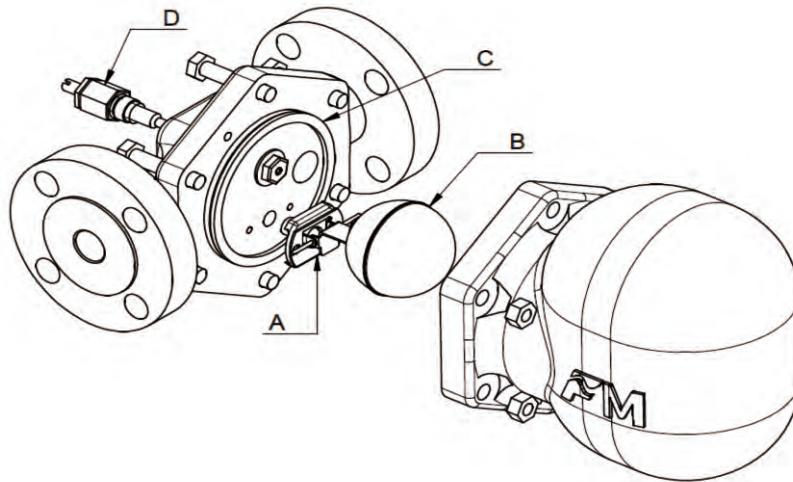

www.forbesmarshall.com

Forbes Marshall Arca

Codel International

Krohne Marshall

Forbes Vyncke

Forbes Marshall Steam Systems

**A:** Forbes Marshall Pvt. Ltd.  
Opp. 106th Milestone, CTS 2220,  
Mumbai-Pune Road, Kasarwadi,  
Pune MH 411034 INDIA  
**P:** +91(0)20-68138555  
**F:** +91(0)20-68138402

**E:** ccmidc@forbesmarshall.com

© All rights reserved. Any reproduction or distribution in part or as a whole without written permission of Forbes Marshall Pvt Ltd, its associate companies or its subsidiaries ("FM Group") is prohibited.

Information, designs or specifications in this document are subject to change without notice. Responsibility for suitability, selection, installation, use, operation or maintenance of the product(s) rests solely with the purchaser and/or user. The contents of this document are presented for informational purposes only. FM Group disclaims liabilities or losses that may be incurred as a consequence of the use of this information.

**Forbes Marshall International Pte. Ltd.**  
16A, Tuas Avenue 1,  
#05-21, JTC Space @Tuas  
Singapore - 639533  
**P:** +65 6219 3890

**CIN No:** U28996PN1985PTC037806